



# IGLU FLAGSTAFF STATION

## PREMIUM STUDIO APARTMENTS



Sleeps 1



Private bathroom



Air conditioning



Unlimited wi-fi

Our premium studios are designed to maximise a shared student living experience, with everything you need for eating, sleeping and studying.

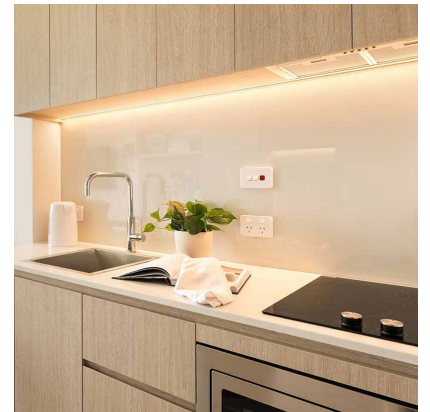

- › Each studio has a private ensuite bathroom and air-conditioning
- › Features well-appointed kitchenette with eating area for self-catering
- › Unlimited high-speed wi-fi included and available throughout

## INSIDE THE STUDIO

As Iglu Flagstaff Station is due to open in July 2026, the images shown are illustrative only. They are indicative of room layouts, finishes and features.

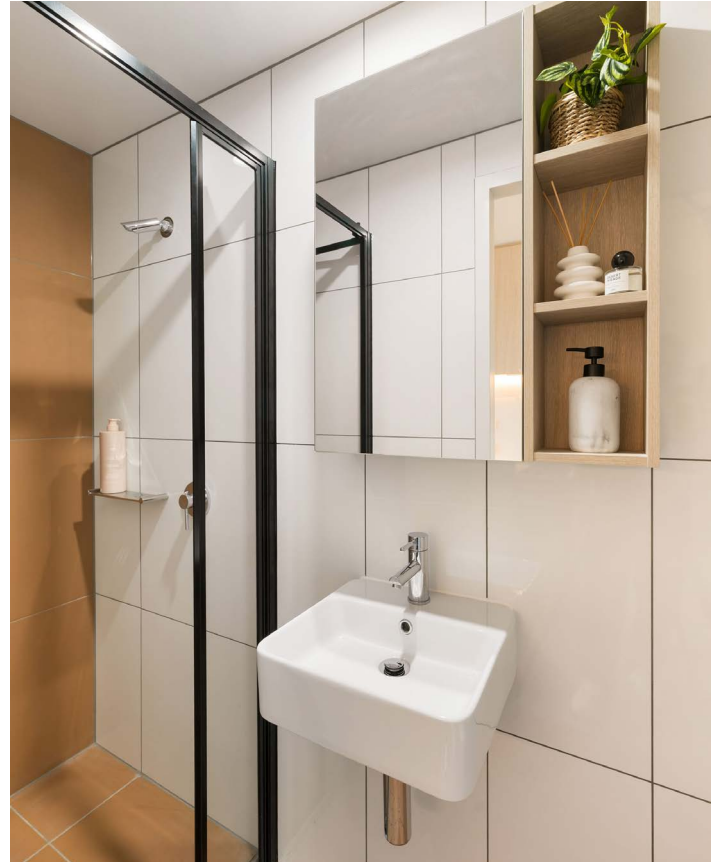

## FEATURES AND INCLUSIONS

### PRIVATE STUDIO APARTMENT

- › Secure swipe card
- › Queen bed with under-bed storage
- › Ensuite bathroom
- › Air-conditioning / heating
- › Wall mounted TV
- › Study desk, lamp, table and chairs
- › Pinboard and bookshelf
- › Built-in wardrobe and full length mirror
- › Kitchenette with microwave, cooktop, refrigerator, kettle and vacuum cleaner
- › Opening windows with block-out and privacy blinds

### ENSUITE BATHROOM

- › Shower
- › Toilet
- › Basin
- › Mirror
- › Towel rail
- › Exhaust fan
- › Storage cabinet and shelving

 Accessible apartments available



### ONE HANDY ALL-INCLUSIVE FEE

Your weekly rent includes all of this plus your water, electricity, access to 24/7 onsite support and lots of cool events.

## IGLU FLAGSTAFF STATION

### PREMIUM STUDIO APARTMENTS

#### MATTRESS SIZE

- › Queen bed: 153 x 203 cm

#### TYPICAL STUDIO LAYOUT

- › Located on levels 2 to 23
- › Approx. 18m<sup>2</sup>



Premium studio offer views over Flagstaff Gardens

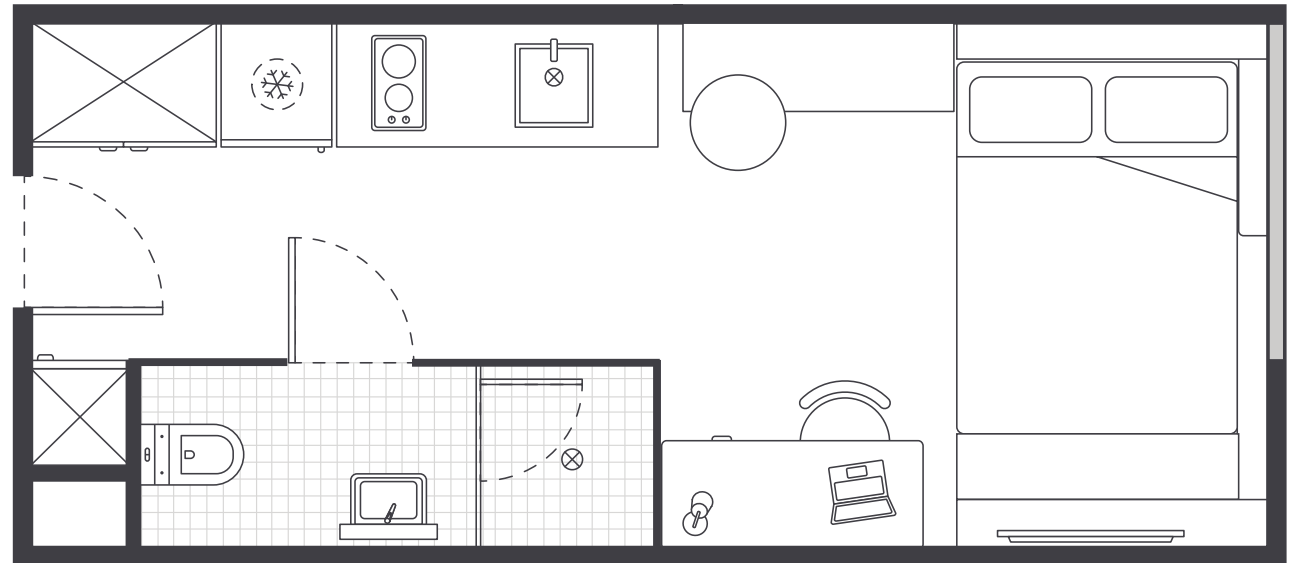

Room allocations are based on availability.

All floorplans are illustrative only and indicative of Iglu's finishes and features.

#### Key



Refrigerator unit



Shelving / storage



Window / glass

## IGLU FLAGSTAFF STATION

### PREMIUM STUDIO APARTMENTS

#### MATTRESS SIZE

- › Queen bed: 153 x 203 cm

#### STUDIO LAYOUT 2

- › Located on levels 2 to 19
- › Approx. 17.5m<sup>2</sup>



Premium studio offer views over Flagstaff Gardens

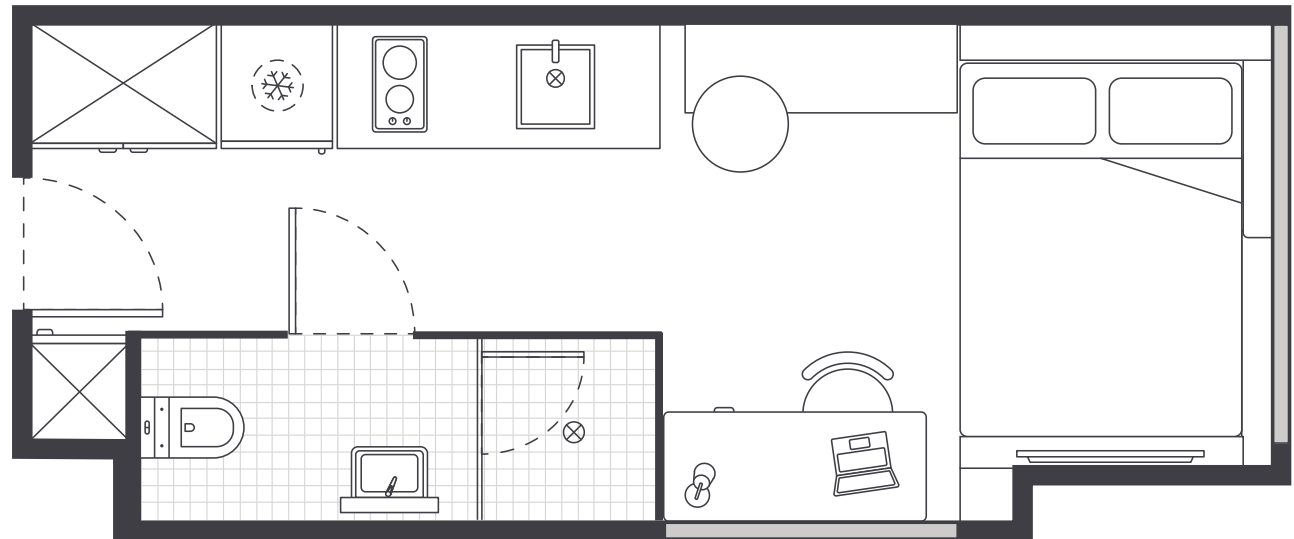

Room allocations are based on availability.

All floorplans are illustrative only and indicative of Iglu's finishes and features.

#### Key



Refrigerator unit



Shelving / storage



Window / glass

## IGLU FLAGSTAFF STATION

### PREMIUM STUDIO APARTMENTS

#### MATTRESS SIZE

- › Queen bed: 153 x 203 cm

#### STUDIO LAYOUT 3

- › Located on levels 12 to 23
- › Approx. 17.5m<sup>2</sup>



Premium studio offer views over Flagstaff Gardens

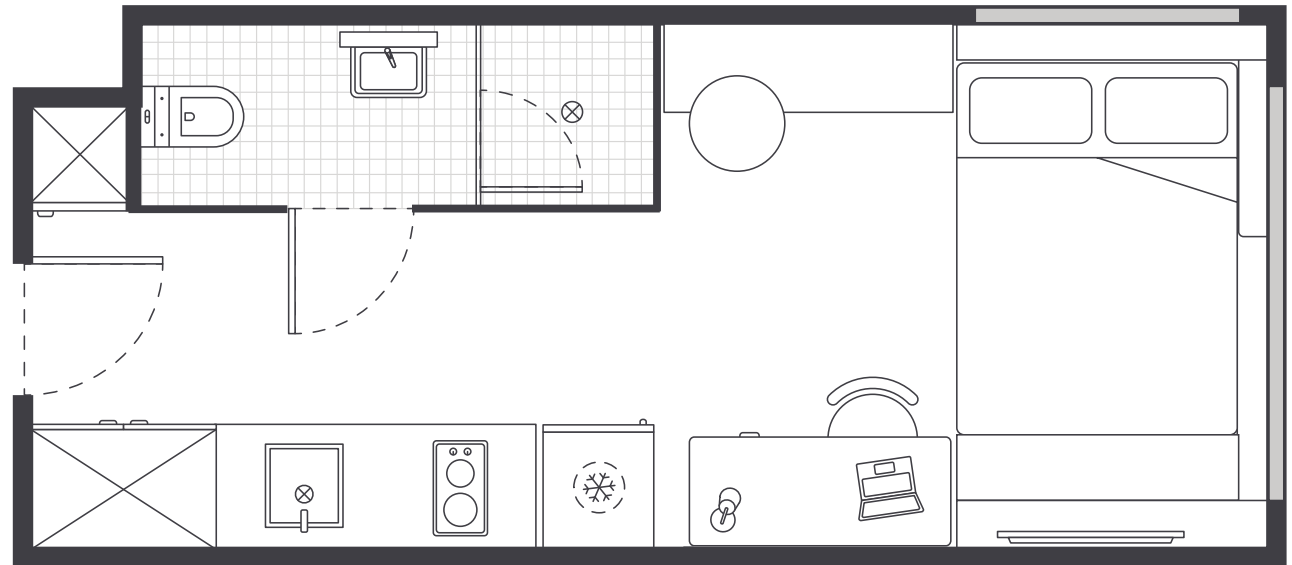

Room allocations are based on availability.

All floorplans are illustrative only and indicative of Iglu's finishes and features.

#### Key



Refrigerator unit



Shelving / storage



Window / glass