

Premium Studio



IGLU MELBOURNE CENTRAL » STUDIO APARTMENTS



PRIVATE BATHROOM



FREE UNLIMITED WI-FI



AIR CONDITIONING



Standard Studio

Our studios are designed to maximise a shared student living experience, with everything you need for eating, sleeping and studying.

- Each fully furnished studio features secure access, double bed, private en-suite bathroom, television, air conditioning, well-appointed kitchenette and eating area.
- Free unlimited high-speed wi-fi is available throughout the building

Sample floor plans

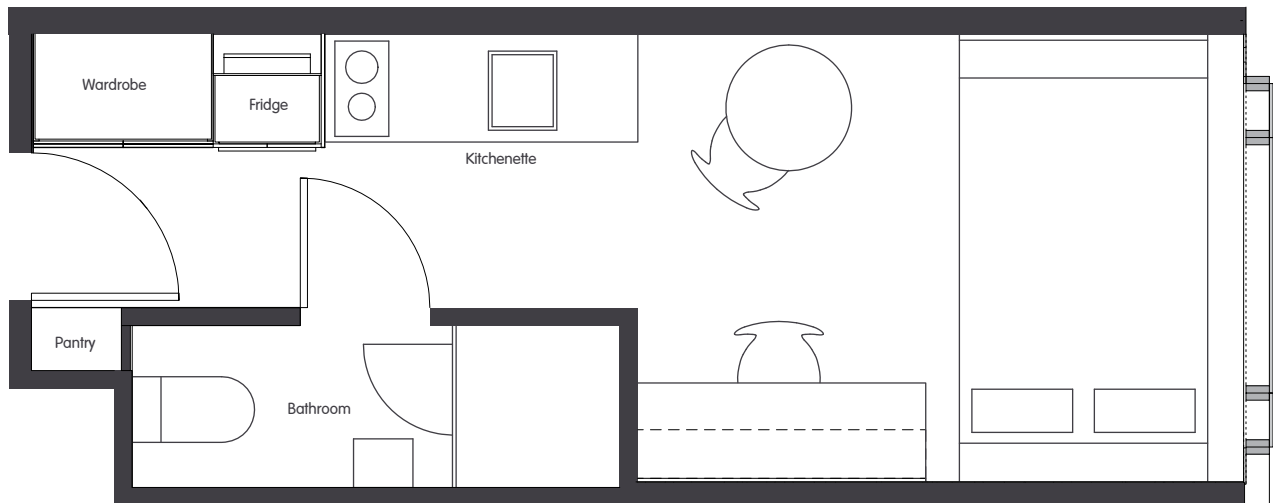

Choose from the following studio types:

Standard – Located on levels 2 to 26, facing Hayward Lane.

Premium – Located on levels 2 to 26, facing Little Lonsdale Street or Russell Street. Higher floors offer district views.

All studio apartments are equipped with:

- › Secure swipe card entry
- › Double bed with built-in storage
- › Private bathroom
- › Air-conditioning and heating
- › Wall mounted television with Apple TV
- › Study desk, chair, lamp, pin board and shelving
- › Wardrobe and full length mirror
- › Table and chair
- › Kitchenette with sink, convection microwave, cook top, refrigerator, toaster, kettle, iron and ironing board
- › Opening windows with blockout blinds

EN-SUITE BATHROOM:

- › Shower
- › Toilet
- › Basin
- › Mirror
- › Storage cabinet
- › Towel rail
- › Exhaust fan

All images are illustrative only and indicative of Iglu's finishes and features



ONE HANDY ALL-INCLUSIVE FEE

Your weekly rent includes all of this plus your water, electricity, gas, access to 24/7 onsite support and lots of cool events.



Iglu Melbourne Central. 167 Little Lonsdale Street, Melbourne VIC 3000

+61 3 9000 8114 ✉ melbournecentral@iglu.com.au f IgluMascot

#livecoolatiglu | iglu.com.au/melbournecentral