



# IGLU CENTRAL PARK

## PREMIUM NRAS\* STUDIOS



Live in your own fully furnished studio apartment, with private living and study space, and friends right next door.

Sound cool?



PRIVATE BATHROOM



WIFI INCLUDED



AIR CONDITIONING



Premium Studio Apartments offer large open plan living and:

- A private en-suite bathroom
- Reverse cycle air conditioning
- A well-appointed kitchenette with eating area to allow for self-catering
- Unlimited high-speed Wi-Fi is included and available in all areas of the building



**ONE HANDY ALL-INCLUSIVE FEE**

Your weekly rent includes all of this plus your water, electricity, gas, access to 24x7 onsite support and lots of cool events.

## Sample floor plan

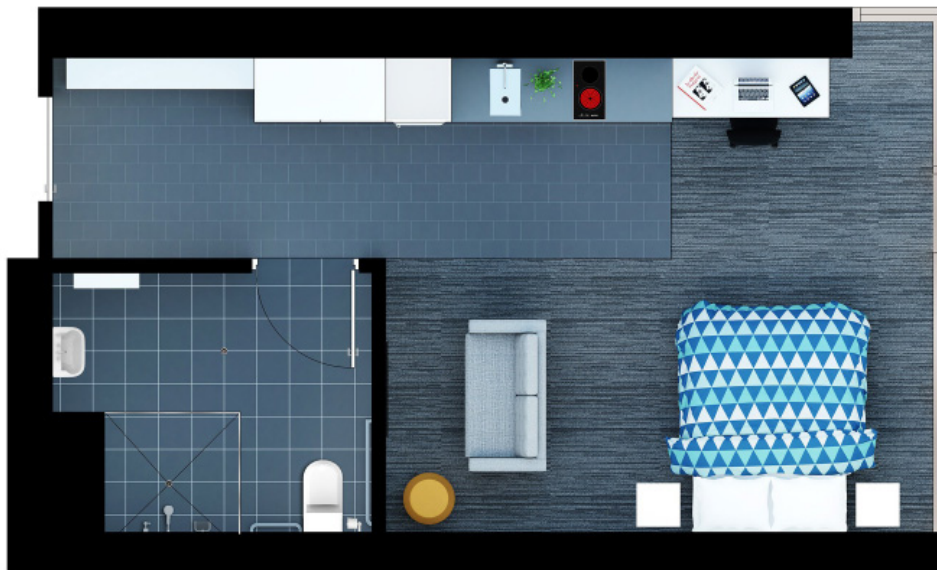

Choose from the following Premium Studio Apartments at Iglu Central Park:

- › **Premium Studio** – located on levels G to 7
- › **Premium Studio Sky** – located on levels 8 to 14 with great views

Each Premium Studio Apartment is equipped with:

- › Secure swipe card access
  - › Wall-mounted HD television
  - › Queen bed
  - › Air-conditioning and heating
  - › Study desk, chair and lamp
  - › Pinboard and bookshelf
  - › Built-in wardrobe and full length mirror
  - › Small sofa
  - › Kitchenette with microwave oven, 2-hot plate cook top, refrigerator, ducted range hood
- Private bathroom has:**
- › Shower
  - › Toilet
  - › Basin
  - › Mirror
  - › Shelving
  - › Towel rail
  - › Exhaust fan
  - › Storage cabinet

**\*National Rental Affordability Scheme (NRAS)**

All premium studio apartments at Iglu Central Park are supported by the National Rental Affordability Scheme (NRAS) with financial assistance from the Commonwealth Government and the New South Wales Government. NRAS rooms are rented at 20% discounts to the market rate of rent. If you apply for one of our NRAS rooms, we'll check your income upfront as part of the process. Further details see [www.iglu.com.au/nras](http://www.iglu.com.au/nras)

All images are illustrative only and indicative of Iglu's finishes and features



**Iglu Central Park.** 6 Central Park Avenue, Chippendale NSW 2008

+61 2 8024 8650 [centralpark@iglu.com.au](mailto:centralpark@iglu.com.au)

**#livecoolatiglu | [iglu.com.au/centralpark](http://iglu.com.au/centralpark)**